

# BJELIN



# Woodura Planks 3.0

EUROPEAN HARDENED TIMBER | 2024/2025 COLLECTION





**SWEDISH SOMMARSTUGA**

Swedes like to spend their free time recharging in nature, preferably in a traditional summer cottage. With a desire for solitude, people escape to the forest, the lush countryside or the seaside.



**FINNISH SAUNA** Saunas are an integral part of Finland's culture. Here, people relieve tension and stress, embracing inner peace. The heat raises the body temperature – essential during colder months – and relaxes the mind.





#### NORWEGIAN HYTTE

The countryside in Norway is dotted with cabins and cottages high up in the mountains and by the coastline. This is where Norwegians traditionally spend time with family and friends, relaxing and enjoying life outdoors.



## Born in *Scandinavia.*

Scandinavians are known for their love of nature and their carefree approach to life.

Our mood is categorised by a sense of tranquillity, prioritising family and friends, and a healthy work-life balance. We value simplicity, equality and due to our strong connection to nature: preserving the environment. Mixed with curiosity, creativity and a passion for innovation, our long-lasting flooring products were born.



**DANISH HYGGE** Hygge means enjoying the good things in life, relaxing by yourself or celebrating the small joys of life with people you care about. It's an opportunity to unwind and take things slow.



## Woodura Planks <sup>3.0</sup>

# Built to last. Designed to impress.

Woodura Planks 3.0 provide a gorgeous and durable foundation for any household. Strengthened by patented technologies, they thrive in lively settings, creating warm and inviting atmospheres. Their natural beauty and grain patterns bring an authentic and timeless feel to any interior. Exceptionally tough and resistant to dents and water, these floors are made from responsibly sourced FSC™ certified European wood, ensuring a long lifespan. These floors have truly revolutionised home living.



**100%  
REAL WOOD**



**3X STRONGER  
IMPACT RESISTANCE**



**HIGHLY WATER  
RESISTANT**



**SUSTAINABLE  
MANUFACTURING**

# Responsible flooring packed with world-class innovations.

Our exceptionally durable hardened wood floors are empowered by the patented Woodura™ technology, which creates a water and dent resistant surface and makes the panels three times stronger. Together with the leakproof 5G Dry™ floor locking system and the moisture-resistant Compositek wood core, these floors can last for generations. Produced with high-quality, responsibly sourced FSC-certified wood, all raw materials are used optimally, creating a more sustainable wood floor.

woodura™

## Product build-up

1. Pro matt lacquer top coat
2. Natural wood covering
3. Wood-based powder layer
4. Välinge Compositek™ core
5. Wood-based powder layer
6. Wood backing layer

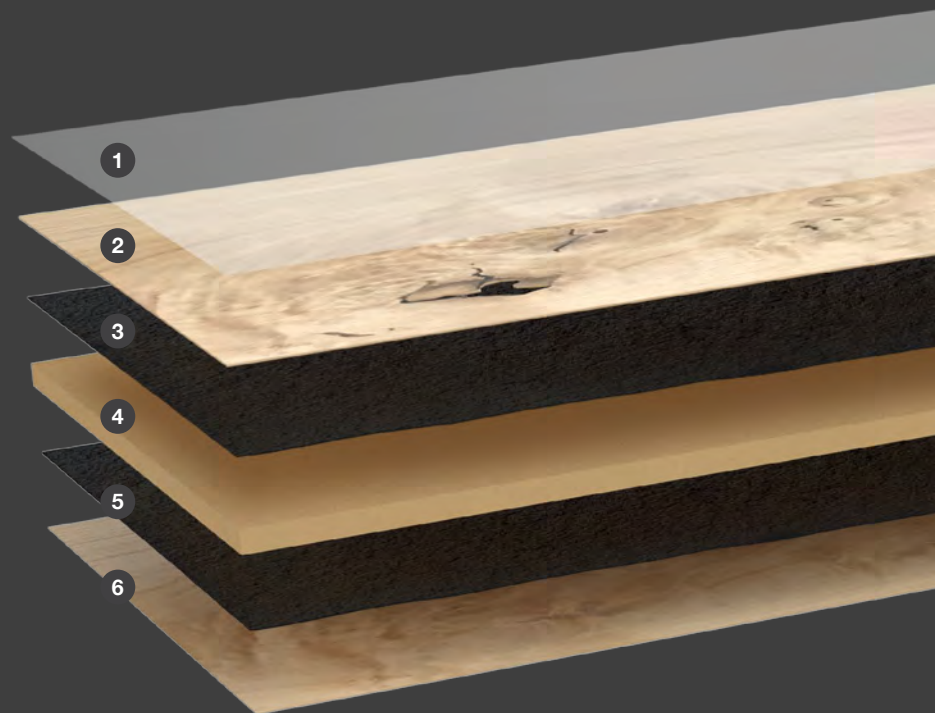



EUROPEAN HARDENED TIMBER

# Lighter *tones* of hardened wood.

Wood floors in lighter tones offer a timeless and versatile aesthetic. By creating an open and airy ambience, these floors can make a room appear larger and more inviting. They also brighten a space by reflecting natural light, making them an adaptable choice that complements various design styles.

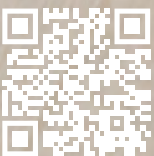

View our vast  
collections online

DALBY 3.0 L  
Powder White, Nature (Oak)





**DALBY 3.0 L**  
Powder White, Nature (Oak)

310003



**HASSLARP 3.0 L**  
Misty White, Nature (Oak)

310002



**LOSHULT 3.0 L**  
Misty White, Select (Oak)

310006



**LOSHULT 3.0 XL**  
Misty White, Select (Oak)

347065



EUROPEAN HARDENED TIMBER

LOSHULT 3.0 L  
Misty White, Select (Oak)



EUROPEAN HARDENED TIMBER

# *Natural* tones of hardened wood.

Natural shades of wood add warmth and elegance to a room. The sense of freshly cut timber brings nature inside, making these versatile floors both aesthetically pleasing and functional. Ideal for cabins and summer houses, these rich and earthy hues are also perfect for a modern or classic home.



View our vast  
collections online

NORRLIA 3.0 L  
Natural, Select (Oak)





**NORRLIA 3.0 L**  
Natural, Select (Oak)

310005



**NORRLIA 3.0 XL**  
Natural, Select (Oak)

347064



**KVARNBY 3.0 L**  
Natural, Nature (Oak)

310001



**KVARNBY 3.0 XL**  
Natural, Nature (Oak)

347049





**ONSLUNDA 3.0 XL**  
Honey, Nature (Oak)

347054



**GANTOFTA 3.0 L**  
Terra Brown, Nature (Oak)

310004





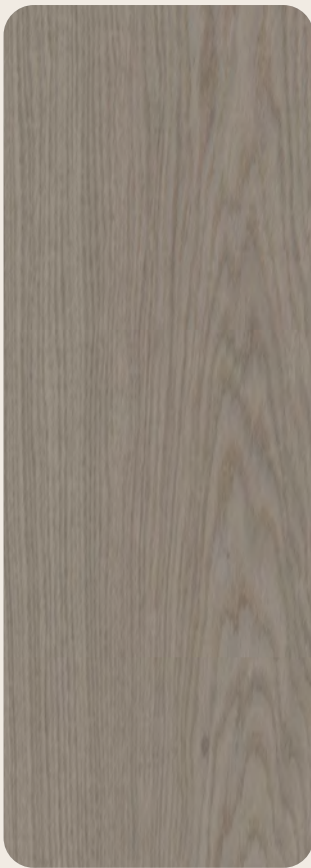

**GRYBY 3.0 L**  
Earth Grey, Select (Oak)

310008

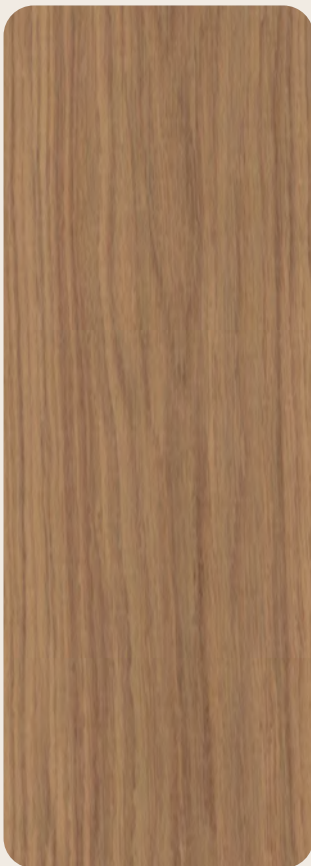

**NOSABY 3.0 XL**  
Honey, Select (Oak)

347068





**STEHAG 3.0 XL**  
Earth Grey, Nature (Oak)

347052





EUROPEAN HARDENED TIMBER

# Darker tones of hardened *wood*.

Darker wood floors are synonymous with style and sophistication. It's an ageless choice that can be both formal and playful. By adding a colourful interior or white walls, bold contrasts can be created for a visual impact. These floors add depth and character and are ideal for a contemporary space.



View our vast  
collections online

**LUGNET 3.0 XL**  
Hard Smoked, Nature (Oak)





**SKIVARP 3.0 XL**  
Mineral Grey, Nature (Oak)

347053



**LUGNET 3.0 XL**  
Hard Smoked, Nature (Oak)

347056



EUROPEAN HARDENED TIMBER



TOLLARP 3.0 XL  
Shadow Brown, Select (Oak)





**TOLLARP 3.0 XL**  
Shadow Brown, Nature (Oak)

347062



EU

## Diverse gr for m

Choose a Select gr  
Nature option for a littl  
lacquer surface treatm  
making it ideal for b

### Select

Select is clean and  
harmonious, with few whole  
knots and color variations.





EUROPEAN HARDENED TIMBER

# Grainings and colour for multiple interiors.

Whether you're looking for a clean look or the authentic character of wood, our products have you covered. Our premium timber stands up to the toughest demands in both residential and commercial settings.

## Blend

Blend mixes the clean and sophisticated Select with the character of Nature.



## Nature

Nature brings the beauty of the outdoors inside, providing an authentic wooden look.



Oak Nature Power

Oak Nature Mist

Oak Nature Earth

Oak Nature Mist

# Easiest installation on the market.

Assemble your floor planks effortlessly with a satisfying click. Our Woodura Planks 3.0 boast the patented 5G Dry® solution, developed by sister company Välinge Innovation, creators of the first mechanical floor locking system.

## 5G Dry – a leakproof solution

The leakproof 5G Dry floor locking system is the latest innovation in floor locking technology. In addition to providing a swift and hassle-free installation, watertight joints prevent water from seeping through the seams and damaging the subfloor.

This locking system has been developed to pass the NALFA and ISO Topical Moisture tests used to assess the behaviour of flooring installations exposed to water and spills. Our Woodura Planks 3.0 meet all the requirements of ISO 4760.

## Installation area

Installation is suitable for most residential and commercial areas, except in bathrooms.

## Area of application

European hardened timber products are suitable for most residential living areas, offices, hospitality, retail etc. The flooring is not suitable for installation in humid rooms (bathrooms, saunas etc.).

Lacquered – suitable for installation in most heavy commercial and residential applications, except bathrooms.

## Cleaning

For the removal of dirt and grime, it is recommended to clean Bjelin's hardened wood with a pH- neutral hardwood surface spray and microfibre mop.

## Underfloor heating

These floors are suitable for underfloor heating. The surface temperature of the floor must never exceed 27° C. See installation instructions. Ensure you follow the installation guidelines and recommendations.

Product name	Species	Grading	Colour	Size	SKU nr
GRYBY	Oak	Select	Earth Grey	L	310008
STEHAG	Oak	Nature	Earth Grey	XL	347052
LUGNET	Oak	Nature	Hard Smoked	XL	347056
NOSABY	Oak	Select	Honey	XL	347068
ONSLUNDA	Oak	Nature	Honey	XL	347054
SKIVARP	Oak	Nature	Mineral Grey	XL	347053
HASSLARP	Oak	Nature	Misty White	L	310002
LOSHULT	Oak	Select	Misty White	L	310006
LOSHULT	Oak	Select	Misty White	XL	347065
KVARNBY	Oak	Nature	Natural	L	310001
KVARNBY	Oak	Nature	Natural	XL	347049
NORRLIA	Oak	Select	Natural	L	310005
NORRLIA	Oak	Select	Natural	XL	347064
DALBY	Oak	Nature	Powder White	L	310003
TOLLARP	Oak	Nature	Shadow Brown	XL	347062
GANTOFTA	Oak	Nature	Terra Brown	L	310004

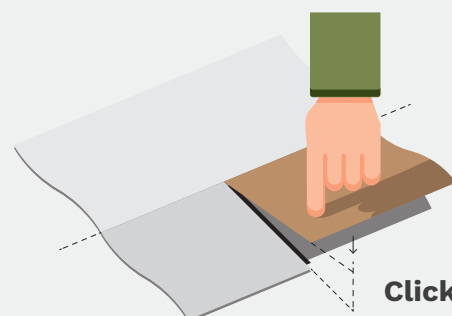

**Click!**

5G – Click the panels into place without nails, glue or sealants.



## TECHNOLOGIES

The 5G® locking system makes it easier than ever to click together a floor. Do it yourself or minimize the project timeline when hiring a professional. Can be installed as a **floating floor** or **glue down**.

©Välinge Innovation AB 2024. All trademarks herein are invented or registered and owned by Välinge Innovation AB. Technologies are subject to patent protection (see [www.valinge.se/patents](http://www.valinge.se/patents)). Nothing herein grants any right to use a technology or trademark without license.



## **Pioneering the future of flooring.**

Bjelin develops, manufactures and sells a broad range of flooring products utilising ground-breaking technologies by sister company Välinge Innovation, the inventor of the click floor. Production takes place in our state-of-the-art factories in Sweden and Croatia, where we have access to top-quality, FSC-certified wood. With a commitment to innovation, we thrive on challenging the norm, looking for new ways to enhance the customer experience, and finding environmentally friendly ways to create flooring products.

Belgotex | Bjelin Distributor

# **BJELIN**

**bjelin.com**  
**belgotex.co.nz**

 [bjelin\\_flooring](#)  [Bjelin](#)  [Bjelin](#)  [Bjelin](#)  [Bjelin](#)